

Shower & Bath

Crystal

Comfort, hygiene and safety for perfect patient and personal care.

Variable height shower stretchers

REF. 3700.00 - 3701.00 - 3800.00 - 3800.20 - 3801.00 - 3860.00 - 3860.20 - 3861.00 - 3865.00

Shower stretchers that combine speed and silence, featuring a mattress designed for optimised washing and an adjustable headrest. Comfort, hygiene and safety for perfect patient and personal care.



Model
3860.00

REVAL
SUSTAINABLE WELL-BEING

Shower & Bath

Crystal

UNIQUE FEATURES



3860.91 Option



- The patient's comfort is ensured by texture of the mattress.
- The triangular headrest can adjust to any position.
- Stainless steel side rails ensure the patient's safety.
- Available in electric or hydraulic models; in standard, elongated, child or obese-sized.
- Rilsan coating.

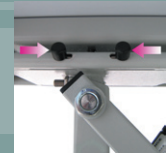

Variable height shower stretchers

REF. 3700.00 - 3701.00 - 3800.00 - 3800.20 - 3801.00 - 3860.00 - 3860.20 - 3861.00 - 3865.00

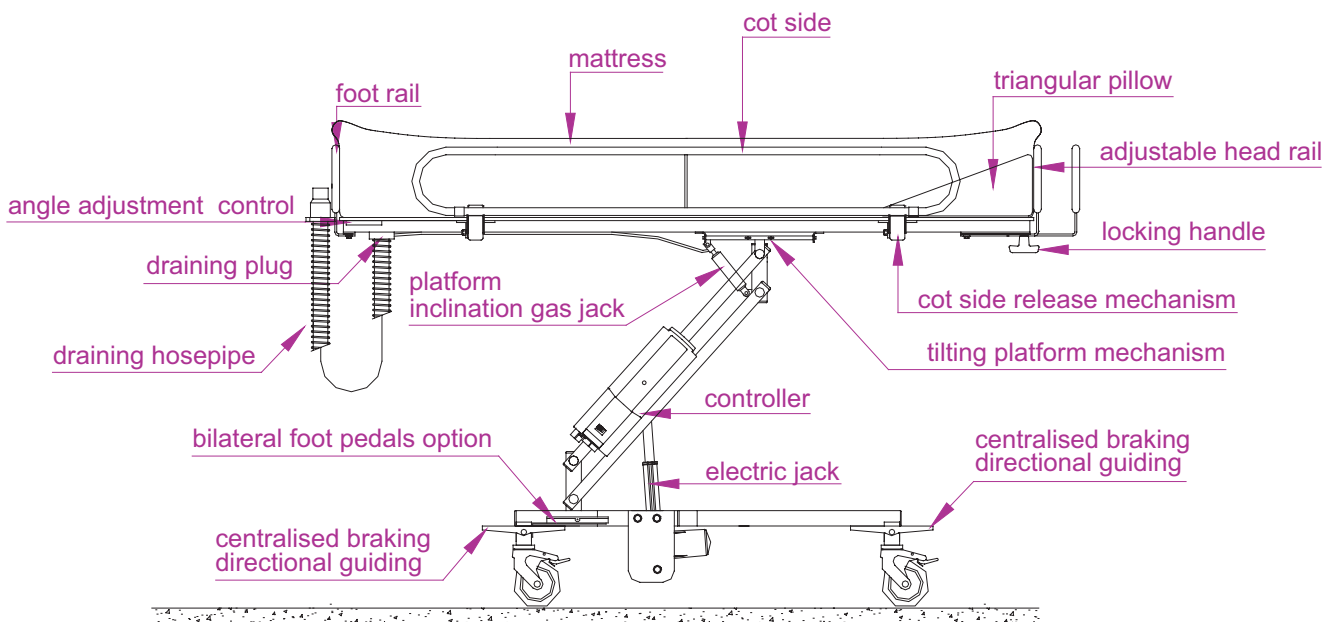

Shower & Bath

Crystal



3011.01 Panel

3012.01 Panel

Variable height shower stretchers

REF. 3700.00 - 3701.00 - 3800.00 - 3800.20 - 3801.00 - 3860.00 - 3860.20 - 3861.00 - 3865.00

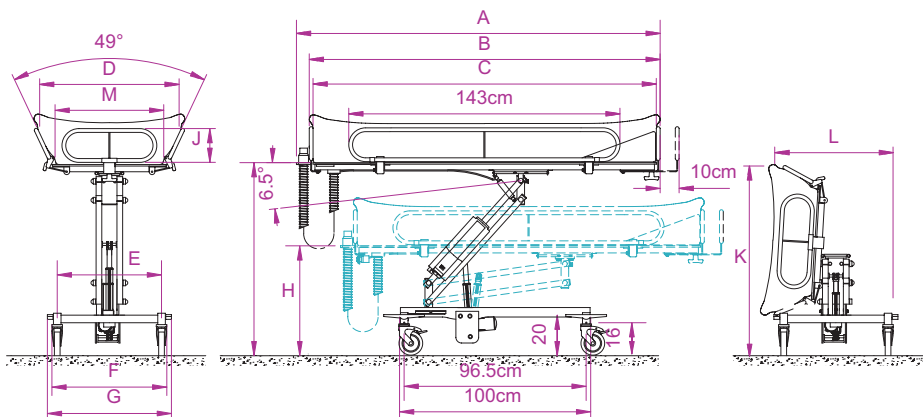

	3700.00	3701.00 STAINLESS STEEL	3800.00	3800.20	3801.00	3860.00	3860.20	3861.00	3865.00
--	---------	----------------------------	---------	---------	---------	---------	---------	---------	---------

HYDRAULIC MODELS	●	●	●	●	●				
ELECTRIC MODELS		●				●	●	●	●
BRAKES ON WHEELS	●	●							
BI-CENTRALISED BRAKING			●	●	●	●	●	●	●
STRETCHER FOLD DOWN			●	●	●	●	●	●	●
GAS-POWERED TILT FUNCTION			●	●	●	●	●	●	

MAXIMUM PATIENT WEIGHT	160 Kg	160 Kg	160 Kg	160 Kg	160 Kg	160 Kg	160 Kg	160 Kg	200 Kg
WEIGHT	60 Kg	60 Kg	65 Kg	60 Kg	68 Kg	70 Kg	65 Kg	73 Kg	92 Kg
CAPACITY AT FULLY CHARGED (??)						40 at 130 Kg	40 at 130 Kg	40 at 130 Kg	20 at 200 Kg

MEASUREMENT "A"	192 cm	192 cm	192 cm	172 cm	202 cm	192 cm	172 cm	202 cm	202 cm
MEASUREMENT "B"	185 cm	185 cm	185 cm	165 cm	195 cm	185 cm	165 cm	195 cm	195 cm
MEASUREMENT "C"	181 cm	181 cm	181 cm	161 cm	191 cm	181 cm	161 cm	191 cm	191 cm
MEASUREMENT "D"	78 cm	78 cm	78 cm	78 cm	78 cm	78 cm	78 cm	78 cm	98 cm
MEASUREMENT "E"	55 cm	55 cm	55 cm	55 cm	55 cm	55 cm	55 cm	55 cm	75 cm
MEASUREMENT "F"	61 cm	61 cm	61 cm	61 cm	61 cm	61 cm	61 cm	61 cm	81 cm
MEASUREMENT "G"	67 cm	67 cm	67 cm	67 cm	67 cm	67 cm	67 cm	67 cm	87 cm
MEASUREMENT "H"	54 cm	54 cm	56 cm	56 cm	56 cm	59 cm	59 cm	59 cm	58 cm
MEASUREMENT "I"	98 cm	98 cm	100 cm	100 cm	100 cm	100 cm	100 cm	100 cm	99 cm
MEASUREMENT "J"	18 cm	18 cm	18 cm	18 cm	18 cm	18 cm	18 cm	18 cm	24 cm
MEASUREMENT "K"			90 cm	90 cm	90 cm	90 cm	90 cm	90 cm	95 cm
MEASUREMENT "L"			68 cm	68 cm	68 cm	68 cm	68 cm	68 cm	74 cm
MEASUREMENT "M"	56 cm	56 cm	56 cm	56 cm	56 cm	56 cm	56 cm	56 cm	76 cm

SPECIFICATIONS: (according to models)

Base

- Steel frame, anti-corrosion coated, painted coating.
- 316L Stainless steel frame for the 3701.00 model.
- 4 x Ø100mm wheels with brakes.
- Bi-centralised braking.
- Bi-directional guiding.
- Hydraulic jack with bilateral foot control or 24V electric jack with 2 functions hand control.

Platform

- White, Polypropylene (unbreakable) stretch.
- Stretcher fold down for easy storage or cleaning.
- Gas-powered tilt function motor with manual control.
- Lateral barrier in stainless steel, outfitted with automatic safety locks.
- Stainless steel foot rail.
- Stainless steel head rail, adjustable over 10cm.
- Stretcher protections.

Mattress

- Water-proof mattress built for intensive use, in soft PVC.
- Central drain hole near feet.
- Ø40mm flexible drain pipe.
- Triangular headrest.

Conformity:

- 93/42/CEE (Medical equipment directive)
- NF EN 12182 (Tech. support systems for handicapped persons)
- NF EN 1441 (Risk analysis for medical equipment)

Options:

- 3860.92 Bilateral foot pedals for electric shower stretchers.
- 3860.93 24V Battery.
- 3700.80 Pole bearing serum bottle.

